

RUE NOTRE-DAME STREET

C/L of the Road

White Painted Line

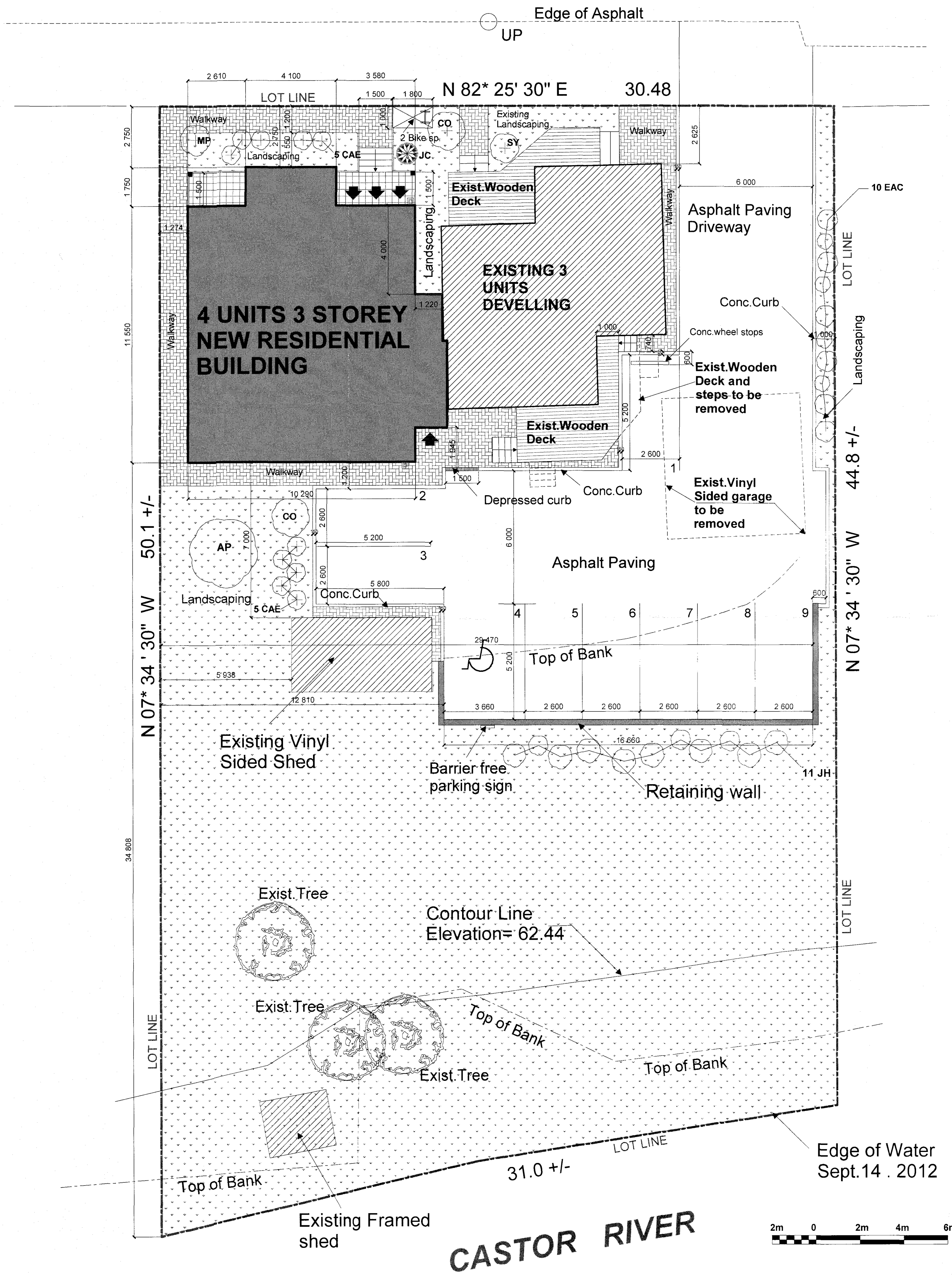

**SITE PLAN**

scale 1:125

**LOT 13 AND THE LANE BETWEEN LOTS 13 AND 15 PLAN BY H.O. WOOD P.L.S. DATED DECEMBER 1, 1863 (REGISTERED 1866) TOWNSHIP OF RUSSELL COUNTY OF RUSSELL**

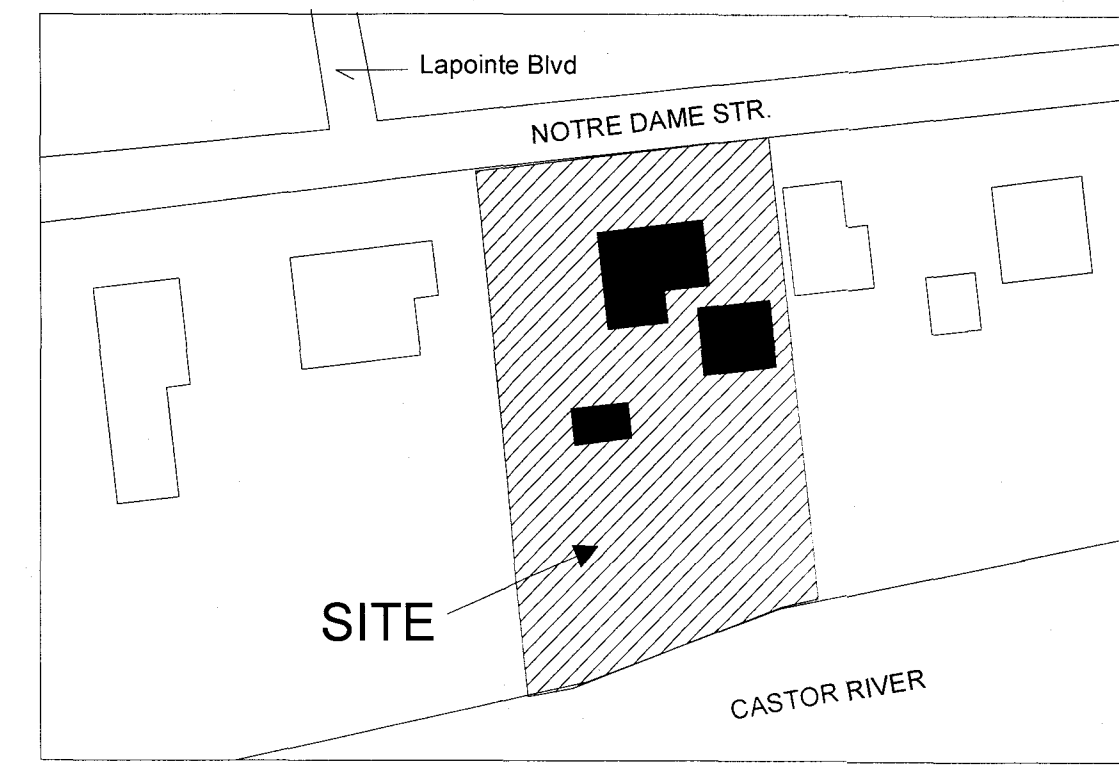

KEY PLAN -----NTS

**R3 - RESIDENTIAL ZONE- Triplex dwelling**

DESCRIPTION	PROVIDED	ZONING BY- LAW
LOT AREA	1455 m2	
LOT FRONTAGE	30.45 m	18.0 m
FRONT YARD SETBACK	2.75 m	6 m
CORNER YARD SETBACK	n/a	n/a
INTERIOR SIDE YARD SETBACK	1.27m	2 m
REAR YARD SETBACK	34.80 m	25% of yard dept max 7.5 m
BUILDING AREA ( New + Exist.)	134.2 m2 + 87.3m2	n/a
BUILDING HEIGHT	10.5 m	10.5 m
PARKING SPACES	9	9
LOT COVERAGE	15.2 %	max 40 %
PARKING SPACE DIMENSIONS	2.6m x 5.2 m	2.6m x 5.2 m
BICYCLE PARKING	2	2

**PARKING SPACE calculation** 7 apartment units x 1.2 ps. = 8.4 PS

**PLANTING SCHEDULE**

QUANTITY	SYMBOL	BOTANICAL NAME	COMMON NAME	SIZE
1	AP	Acer platanoides	Norway maple	75 mm
1	MP	Malus Profusion	Crabapple	60 mm ∅
2	CO	Celtis occidentalis	Common hackberry	150 cm ∅
1	JC	Juniperus communis	Juniper	80 cm pots
10	CAE	Cornus alba	Red Barked Dogwood	80 cm pots
10	EAC	Euonymus alatus compacta	Dwarf Burning Bush	50 cm pots
1	SY	Syringa vulgaris	Common Lilac, French Lilac	100 cm
11	JH	Juniperus horizontalis 'Blue Mat'	Blue Rug Juniper	40 cm pots

**LANDSCAPING NOTES**

- Generally, all site work to conform with the general landscape specification of "Landscape Ontario". Copies can be obtained from "Landscape Ontario", 1293 Matheson Blvd., Mississauga, Ontario, L4W 1R1.
- Check all quantities and report any errors or discrepancies to the landscape architect.
- Acceptance of plant material at its source does not prevent rejection on site prior to or after planting operations.
- Plant material to be No. 1 grade and when supplied in containers and/or wire baskets (now bio-degradable), the entire encasement is to be removed without disturbing root ball prior to backfilling.
- Container grown stock shall not have been grown in container for more than 2 growing seasons. Plants must be able to "hold" soil once removed from container, and plants that have become root bound are not acceptable.
- All shrubs or trees in groups to be planted in continuous mulched beds as indicated on plan.
- Use plant material true to name, sizes, or grades, as specified and conforming to the standards of the Canadian Nursery Trades Association. Substitutions not permitted unless written approval has been obtained but must be of similar species and of equal size as those originally specified.
- All sod to be No. 1 nursery sod, smoothly lain with tight joints and within 36 hours of being lifted. Maintain sodded area from start of insulation until final acceptance.
- All sizes indicated are minimum.

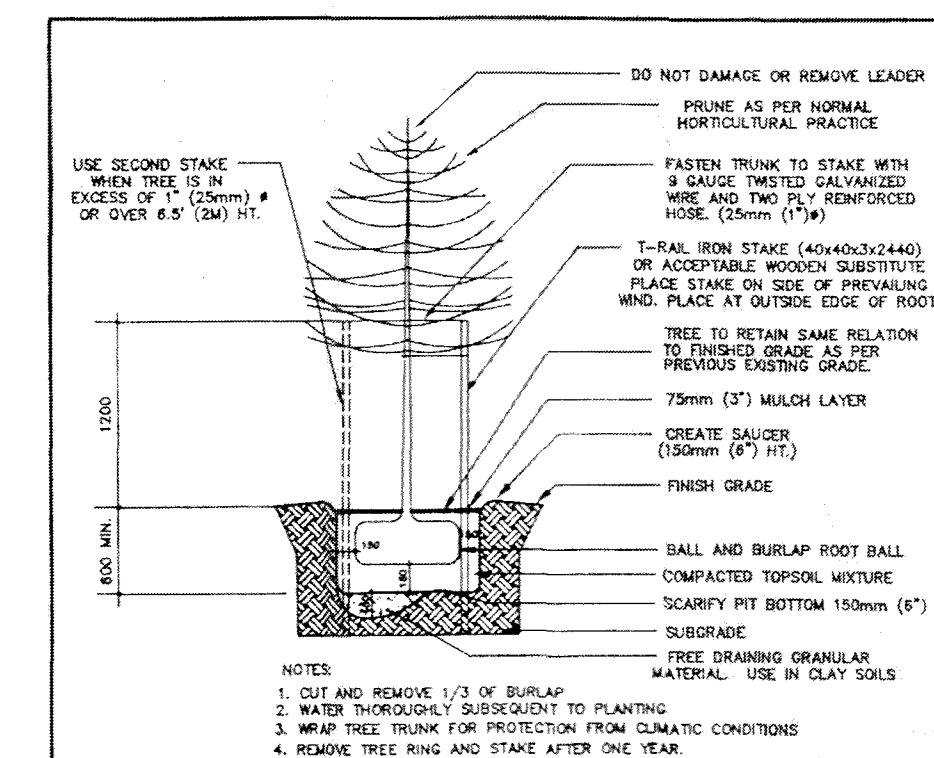

TREE PLANTING DETAIL-----NTS

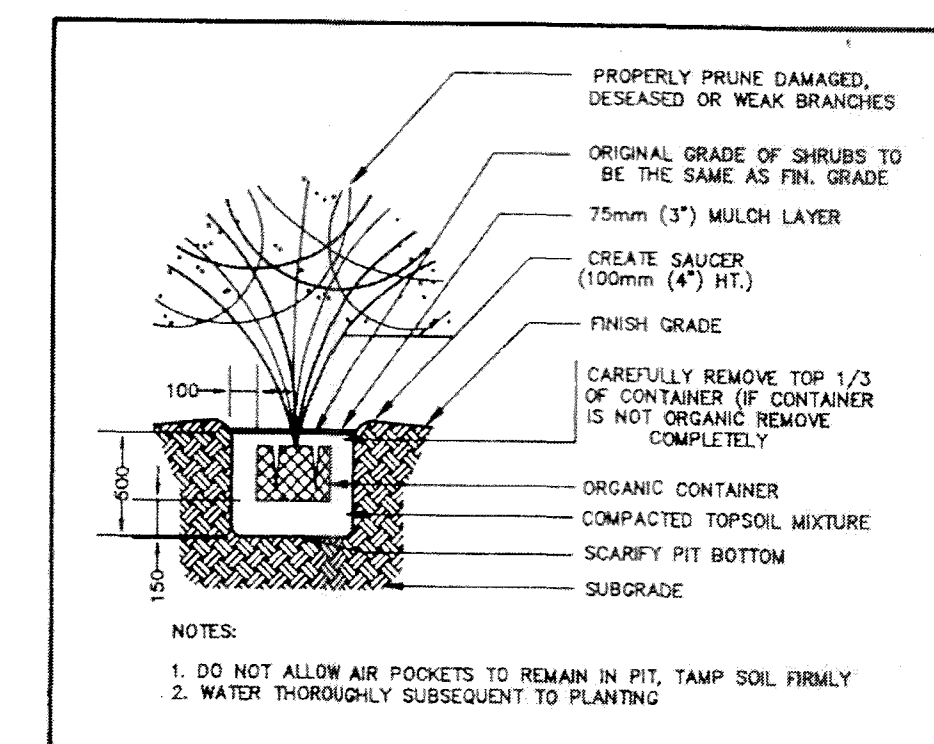

SHRUBS PLANTING DETAIL-----NTS

Copyright Reserved  
The Contractor shall verify and be responsible for all dimensions. DO NOT scale the drawings - any errors or omissions shall be reported to A. Dagenais & Assoc. Inc. without delay. The copyrights to all designs and drawings are the property of A. Dagenais & Assoc. Inc. Reproduction or use for any purpose other than that authorized by A. Dagenais & Assoc. Inc. is forbidden.

**LEGEND**

- Lot Line
- ↑ Entrances-Exits
- Landscaping
- New Balcony and patio
- Walkway
- Exist. wooden deck
- Retaining wall
- Removed wood stair
- Bike rack
- Site lighting

#	Revision	Date
#5		
#4		
#3		
#2		
#1	Issued for Municipal approval	December 08/2016

**A. Dagenais & Assoc. Inc.**  
CONSULTING ENGINEERS & ARCHITECT  
INGENIEURS CONSEILS & ARCHITECTES  
931, Notre Dame, P.O. Box 160  
Embrun, Ontario, K0A 1W0  
(613) 893-0700

**Proposed 3 storey Addition  
Fritz Pierre**  
1070 Rue Notre Dame, Embrun, ON  
Site Plan  
Date: Decembre 2016  
Folder #: \_\_\_\_\_  
Drawn by: T.B.  
Revised by: A.F.D.

Stamp: LICENSED PROFESSIONAL ENGINEER  
A. DAGENAIS  
10/09/2016  
PROVINCE OF ONTARIO

Page number: **SP1**